

Ex-e/Ex-i terminal box

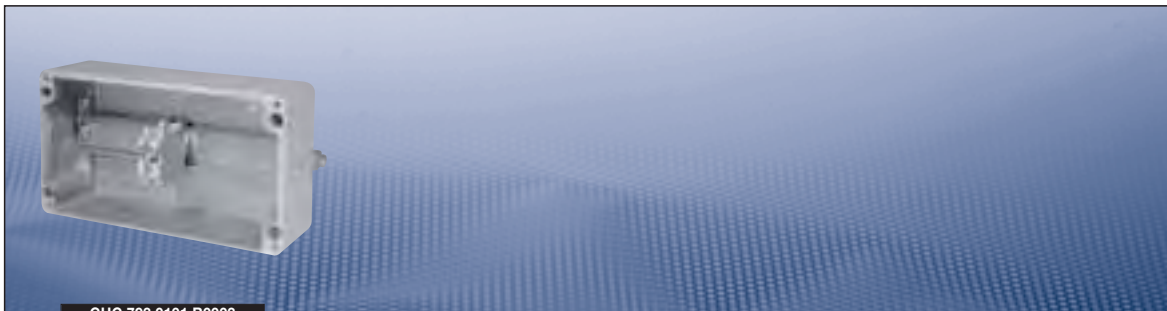

GHG 793 0101 R0003

Technical data

Type 793 01 up to 11 terminals

Marking to 94/9/EC	Ⓔ II 2 G Ex dem ia II, IIC T6 / Ⓔ II 2 D A21 IP66 T80 °C						
Permissible ambient temperature	-20 °C to +40 °C -55 °C to +55 °C (option)						
EC-Type Examination Certificate	PTB 00 ATEX 3108						
Rated voltage	up to 690 V						
Rated current	depends on terminal mounting						
Degree of EN 60529	IP66						
Enclosure material	light alloy die-casting (AlSi)						
Enclosure colour	light grey						
Terminal cross section	up to 6 mm ²						
Weight	approx. 0.68 kg						
Drillings/cable glands	M16	M20	M25	M32	M40	M50	M63
Max. number down	5	2	2	1	-	-	-
Max. number of terminals acc. to certification	2.5 mm ²		4 mm ²		6 mm ²		
	16		14		10		

Ordering details

Design	Cable gland	No. of Terminals	Order No.
Typ 793 01 up to 11 terminals with screw terminals 2 x 2.5 mm ² + PE-terminal 2 x 4 mm ²			
Ex-e	without drilling	1 x Ex-e*/1 x PE	GHG 793 0101 R0003

* according to type examination certificate individual open ended

Dimension drawing

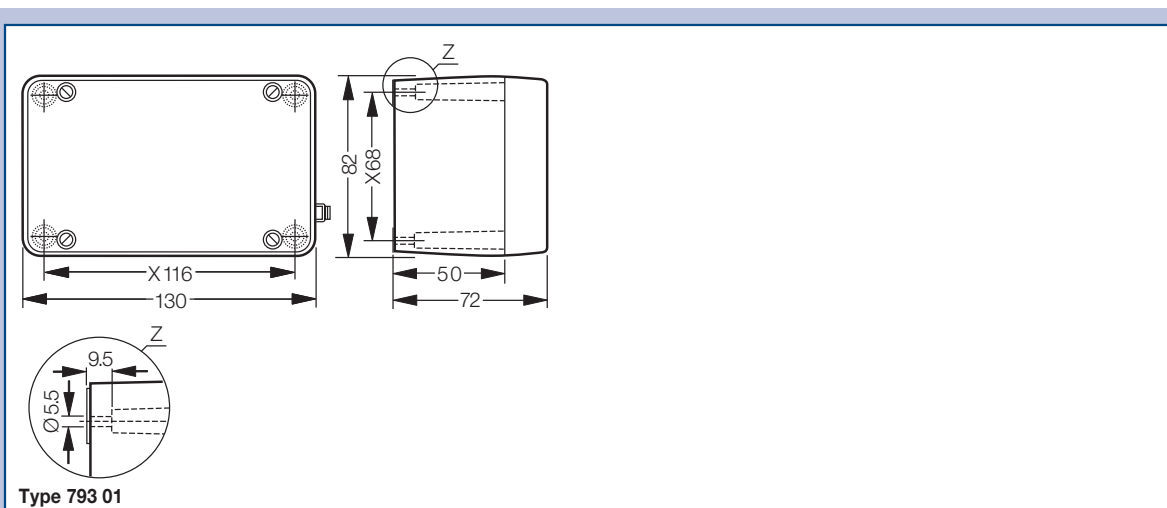

Dimensions in mm



Technical data

Type 723 00 | 723 10 | 723 20 up to 96 terminals

Marking to 94/9/EC	Ⓔ II 2 G Ex de ia/ib [ia/ib] m IIC T4 / Ⓔ II 2 D Ex tD A21 IP66 T 80 °C
Permissible ambient temperature	-20 °C to +40 °C -55 °C to +55 °C (option)
EC-Type Examination Certificate	PTB 99 ATEX 1044
Rated voltage	up to 690 V
Rated current	depends on terminal mounting
Degree of EN 60529	IP66
Enclosure material	light alloy die-casting (AlSi)
Enclosure colour	light grey

Type 723 00 up to 24 terminals

Terminal cross section	max. 35 mm ²						
Weight	approx. 1.41 kg						
Max. number drillings/cable glands down	M16	M20	M25	M32	M40	M50	
	8	4	3	-	-	-	
Terminal mounting space on the terminal rail	1 x 185 mm						
Max. number of terminals acc. to certification	2.5 mm ²	4 mm ²	6 mm ²	10 mm ²	16 mm ²	25 mm ²	35 mm ²
	24	24	18	18	14	-	-

Type 723 10 up to 82 terminals

Terminal cross section	max. 50 mm ²						
Weight	approx. 3.84 kg						
Drillings/cable glands	M16	M20	M25	M32	M40	M50	
Max. number down	22	10	7	4	3	2	
Terminal mounting space on the terminal rail	2 x 242 mm						
Max. number of terminals acc. to certification	2.5 mm ²	4 mm ²	6 mm ²	10 mm ²	16 mm ²	25 mm ²	35 mm ²
	2 x 41	2 x 34	2 x 26	2 x 20	1 x 17	1 x 17	1 x 14

Type 723 20 up to 96 terminals

Terminal cross section	max. 95 mm ²						
Weight	approx. 4.87 kg						
Drillings/cable glands	M16	M20	M25	M32	M40	M50	
Max. number down	30	18	10	6	5	4	
Terminal mounting space on the terminal rail	3 x 362 mm						
Max. number of terminals acc. to certification	2.5 mm ²	4 mm ²	6 mm ²	10 mm ²	16 mm ²	25 mm ²	35 mm ²
	2 x 48	2 x 48	2 x 36	2 x 36	1 x 28	1 x 23	1 x 22

Ex-e/Ex-i terminal box



Ordering details

Design	Cable gland	No. of Terminals	Order No.
Type 723 00 mounted with screw terminals 2 x 2.5 mm ² + PE-terminal 4 mm ²			
Ex-e	without drilling	1 x Ex-e ¹⁾ /1 x PE	GHG 723 0001 R0002
Type 723 10 mounted with screw terminals 2 x 2.5 mm ² + PE-terminal 4 mm ²			
Ex-e	without drilling	1 x Ex-e ¹⁾ /14 x PE	GHG 723 1001 R0002
Type 723 20 mounted with screw terminals 2 x 2.5 mm ² + PE-terminal 4 mm ²			
Ex-e	without drilling	1 x Ex-e ¹⁾ /14 x PE	GHG 723 2001 R0002

¹⁾ according to type examination certificate individual extensible

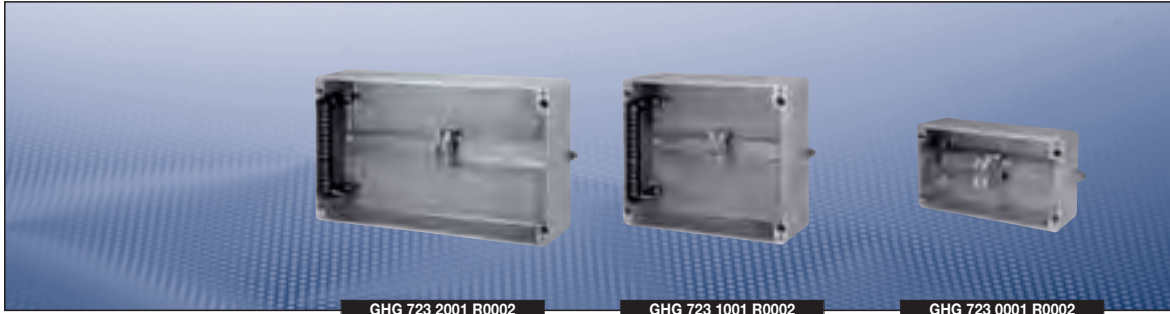

GHG 723 2001 R0002

GHG 723 1001 R0002

GHG 723 0001 R0002

Dimension drawing

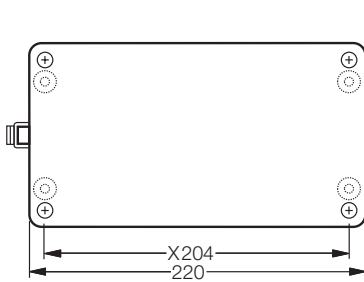

Type 723 00

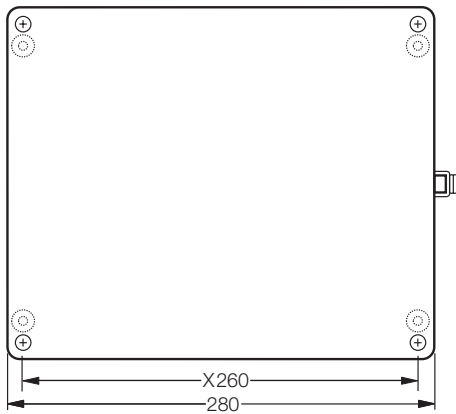
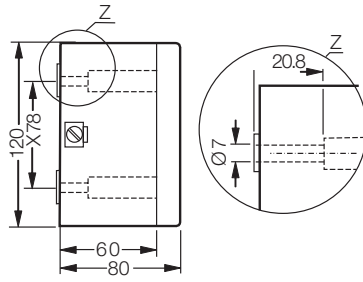

Type 723 10

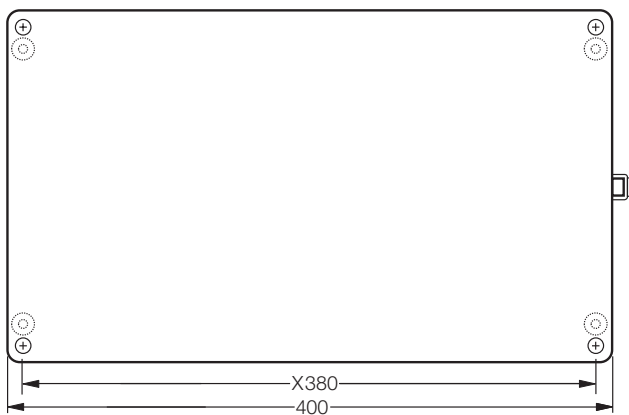
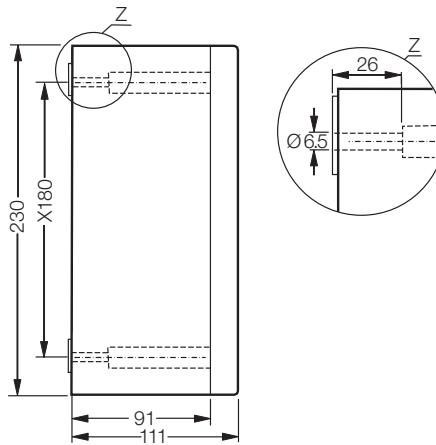

Type 723 20

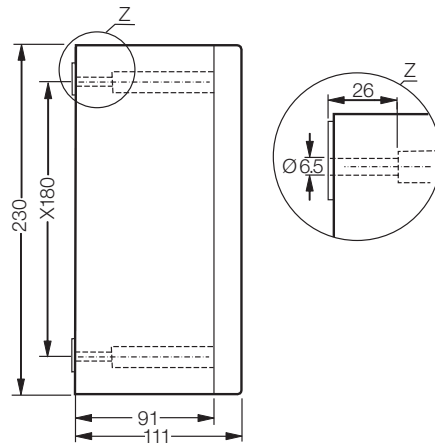

X = mounting dimension

Dimensions in mm

1
2
3
4
5
6
7
8
9
10
11
12